

"VICTORIA" HORIZONTAL - INSTRUCTIONS FOR ASSEMBLY-FACE FIX APPLICATION

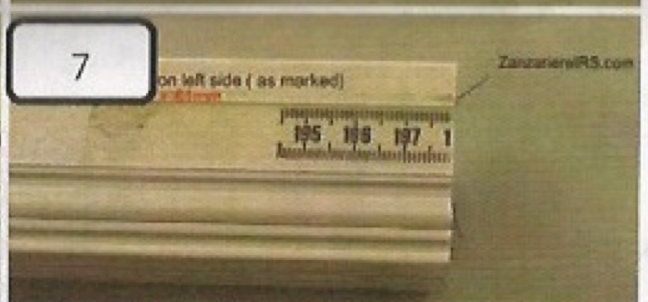

WATCH THE ASSEMBLY VIDEO

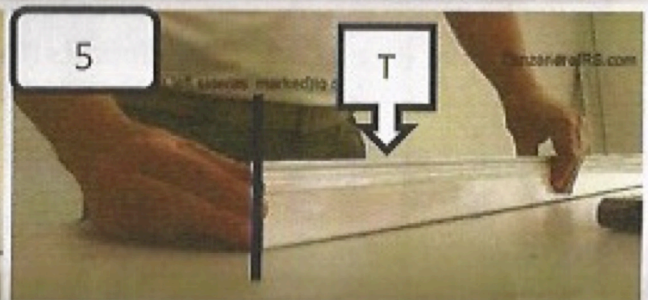

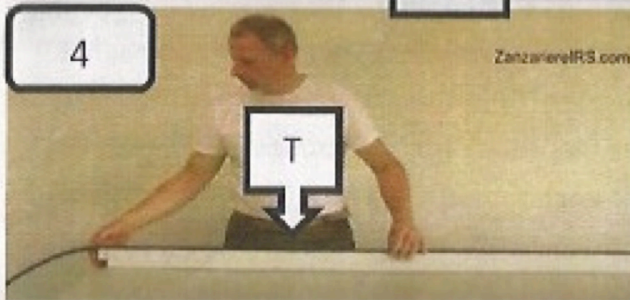
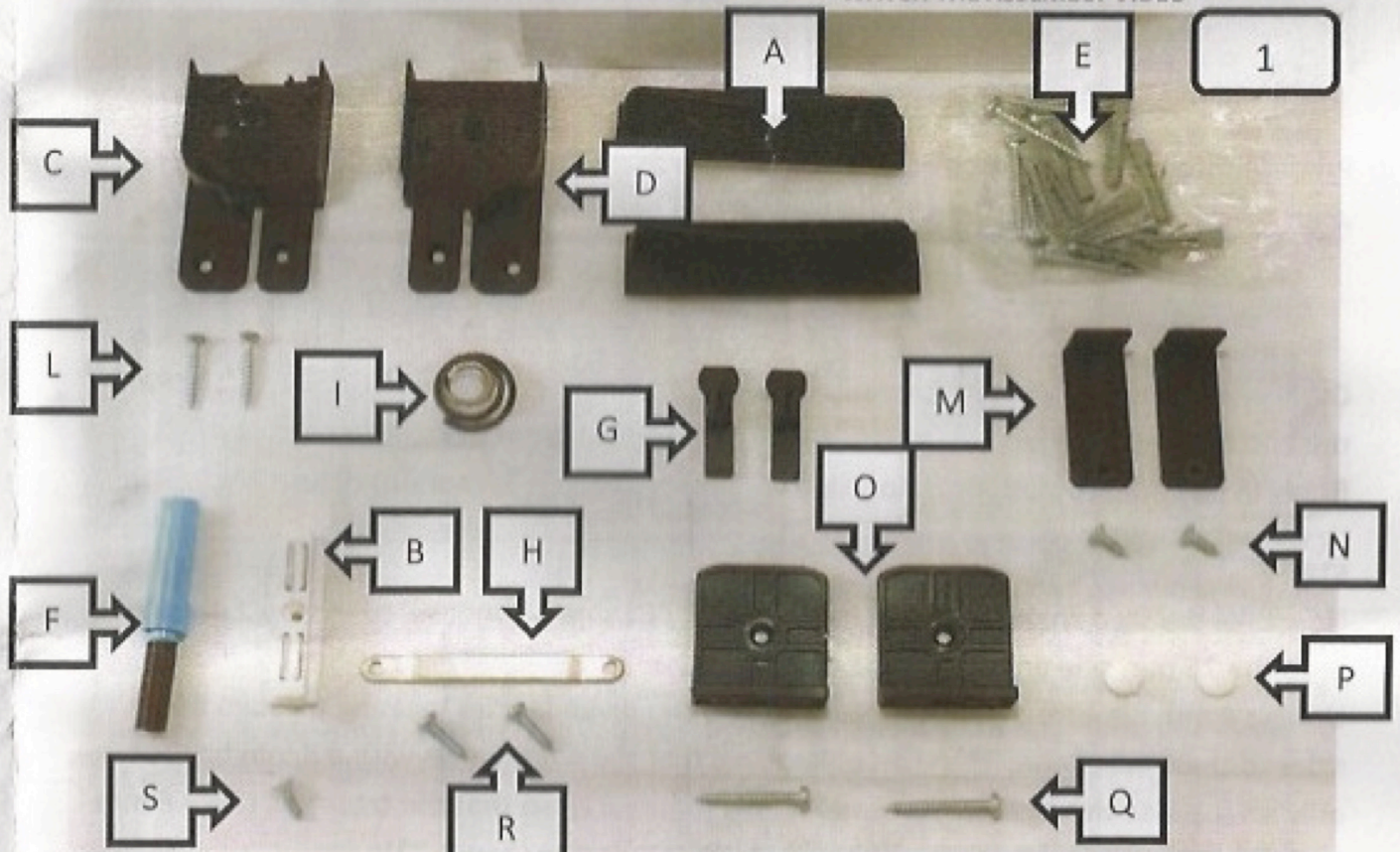
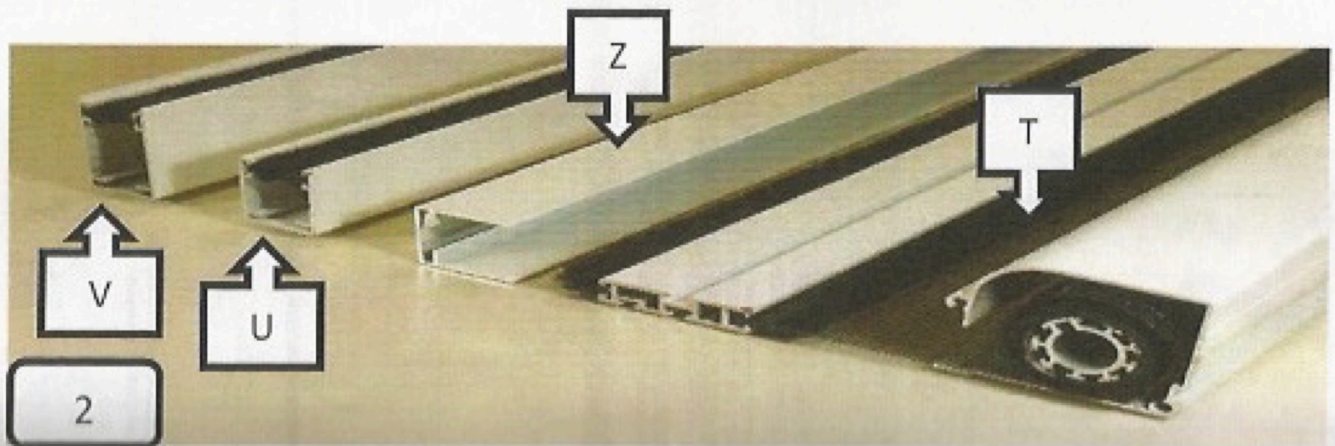

LIST OF COMPONENTS

Figures 1-2)

- A – Handles
- B – Magnetic catch
- C – Roller cartridge left end cap
- D – Roller cartridge right end cap
- E – Screen fixing screws
- F – Brake mechanism
- G – Pull bar end caps
- H – Magnetic catch plate
- I – Cone spring
- L – Screws for end cap
- M – Track supports
- M – Screws for track supports
- O – Roller cartridge supports (frontal fixing)
- P – Plugs (frontal fixing)
- O – Screws for supports (frontal fixing)
- R – Plate fixing screw
- S – Magnet fixing screw
- T – Roller cartridge and pull bar
- U – Floor track, 25 mm
- V – Top track, 36 mm
- Z – Stop channel

STEP 1

Measure the height "H" of the door opening, in millimetres (Figure 3, e.g. 1918 mm)



STEP 2

Remove the brush seal strip from the groove in the pull bar (figure 4)

Check that the profiles (T - cartridge + pull bar) are aligned at the end where the cut is to be made (figure 5). Identify the measurement by way of the ruler printed on the cartridge,

using the formula:

$$\text{Height } H + 61\text{mm} \quad \text{example } 1918 \text{ mm} + 61\text{mm} = 1979$$

Cut through the cartridge, bar and screen together. (figures 6-7)

Remove any burrs and waste left by the cut.

STEP 3

Take the left end cap (C) with the relative screws (L), and the brake (F), from the box of accessories (figure 8); fit the brake to the pivot of the cap (C), turning as necessary (figure 9). Insert the assembled part into the tube and secure in position with the screws (L) provided (figures 10-11).

STEP 4

Fit the handles (A) to the pull bar, one on each side, taking care that the grips are the right way around for operating purposes: their final position on the bar will be adjusted during the course of subsequent steps (figures 12-13).

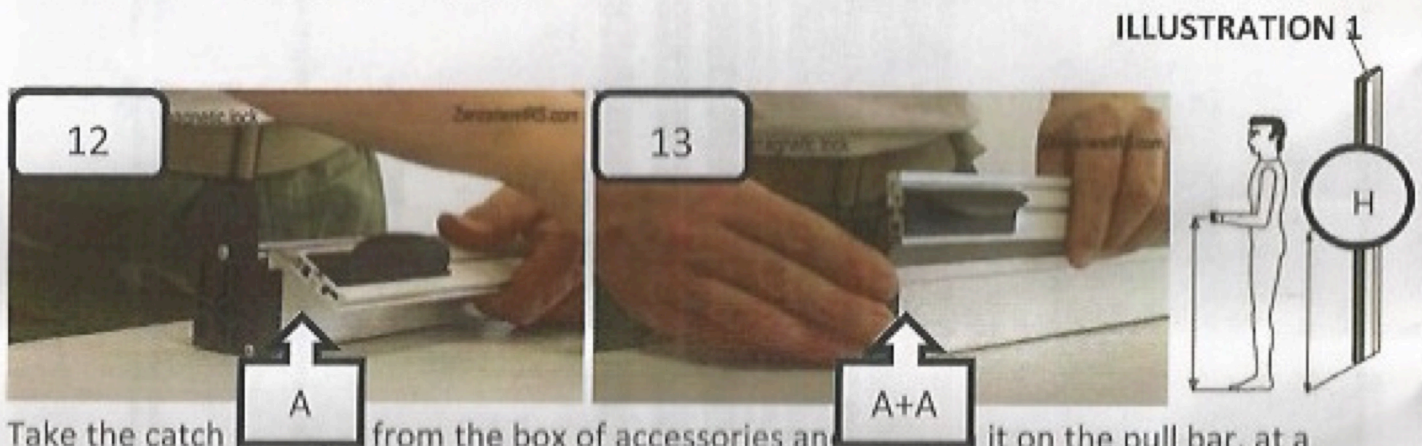

Take the catch (A) from the box of accessories and fit it on the pull bar, at a height that will be comfortable for users of the screen. (ILLUSTRATION 1) assuming that the height of an adult's forearm when parallel to the ground is 100 cm, the part must be positioned at around 100 cm from the end of the bar resting on the floor (figure 14). Having positioned the plate (H) on the pull bar, drill through the metal with a 3 mm bit at points coinciding with the holes in the plate. Fix the plate in position with the screws (R) provided (figures 15-16).

Slide the handles (fitted previously) along the pull bar and position them at the height of the plate (H) (figure 17)

Now fit the brush seal strip removed earlier from the pull bar (step 2), first from one end and then from the other (figure 18). Once the inserted end of the strip is in contact with the plate fixed previously (figure 19), trim off the surplus at the other end (figure 20).

Fit the end cap (G) to the exposed end of the pull bar profile (figures 13-14).

Repeat the operation on the opposite end of the pull bar.

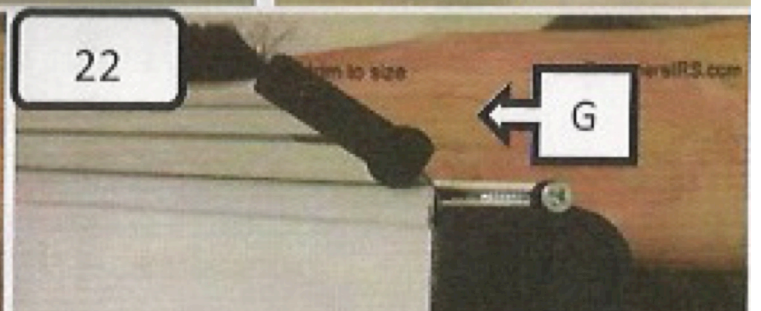
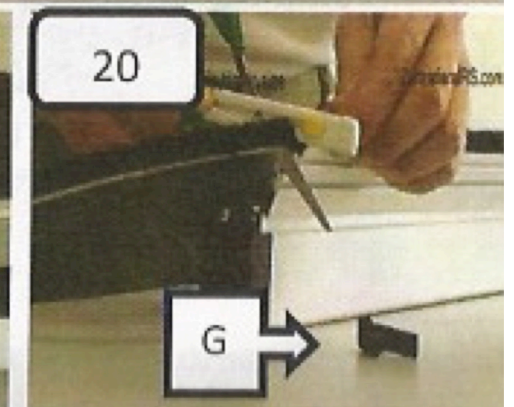
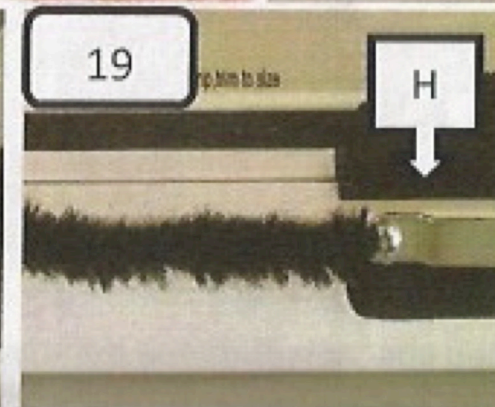
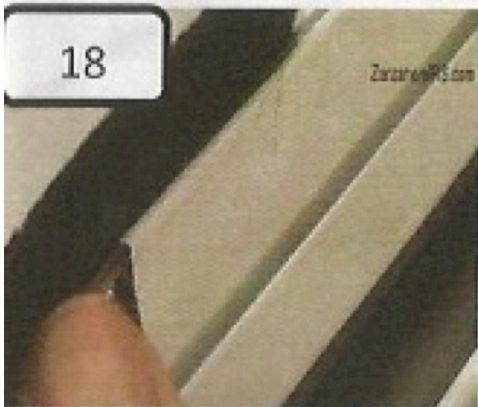
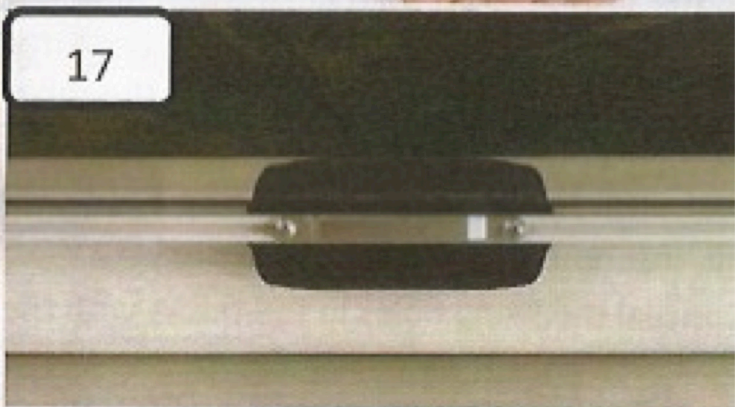
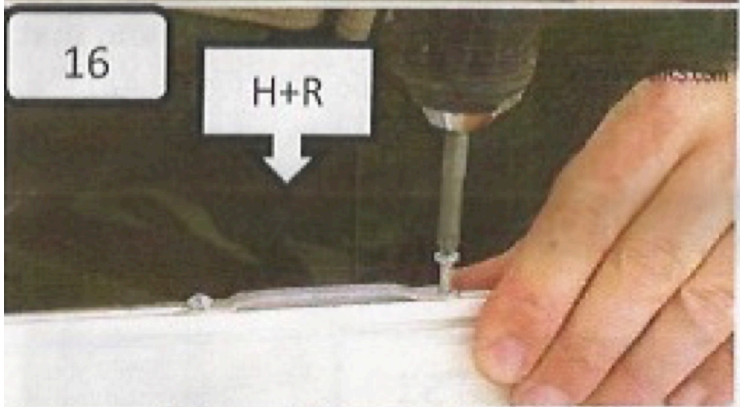
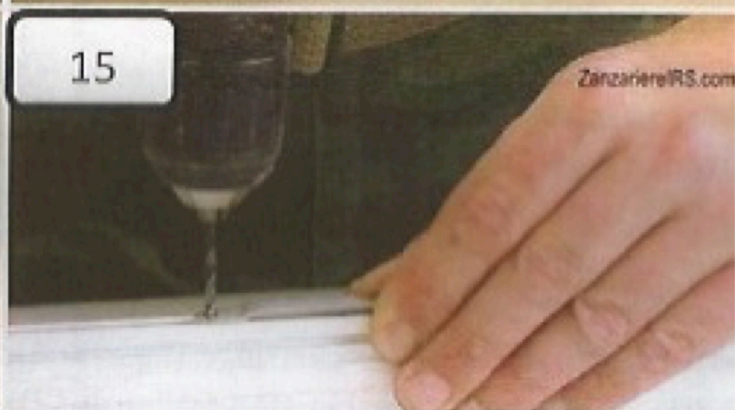
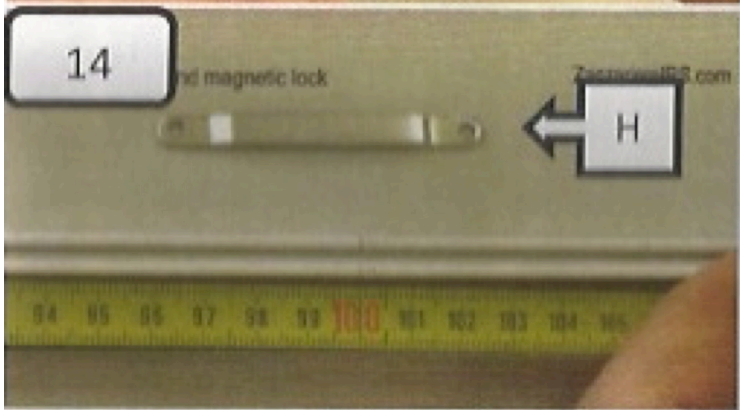
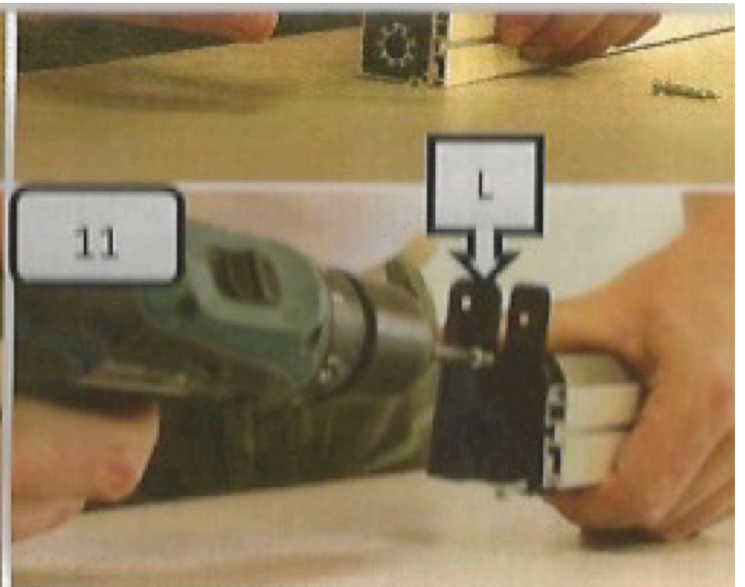
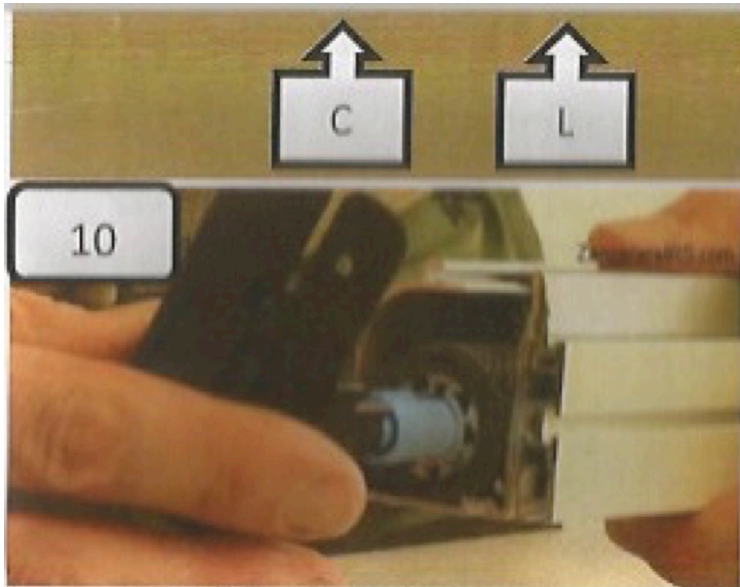

STEP 5

Measure the width "W" of the door opening, in millimetres (figure 23)



Prepare the two screen tracks: (V) – height 36 mm and (U) – height 25 mm (figure 24), align the brush strips at the ends (figure 25), and determine the position of the cut =

$$\text{Width W} + 25\text{mm} \quad \text{example } 997 \text{ mm} + 25 \text{ mm} = 1022 \text{ mm}$$

Cut the two tracks (V+U) together, and remove any burrs and waste (figures 26-27). Pinch the end of the profile slightly, where the brush strip is seated. (The strip must be held firmly in position, so that it cannot slide when the screen is in motion) (figure 28).

STEP 6

Now take the stop channel (Z), cut it to size ("H"+61 mm) as measured in step 2, turn it onto the 25 mm side and divide the cut length into three equal parts (figures 29-30). Using a 4 mm bit, drill a centre on each of the two dividing lines, passing through both sides of the track (figure 31), then enlarge each of the 4 mm holes with a 8 mm bit, but only on the side that will be exposed to view (figure 32), so that the track has three 8 mm holes on one side and three 4 mm holes on the other side (figure 33).

Take the magnet (B) and the track supports (M) with the relative fixing screws (N+S) from the box of accessories (figure 34). Locate the magnet (B) in the grooves of the track (Z) and slide it approximately half-way along the profile, ready for the subsequent fixing step (figures 35-36). Fit the track supports (M) one to each end of the track (Z), locating them in the grooves of the profile (figures 37-38).

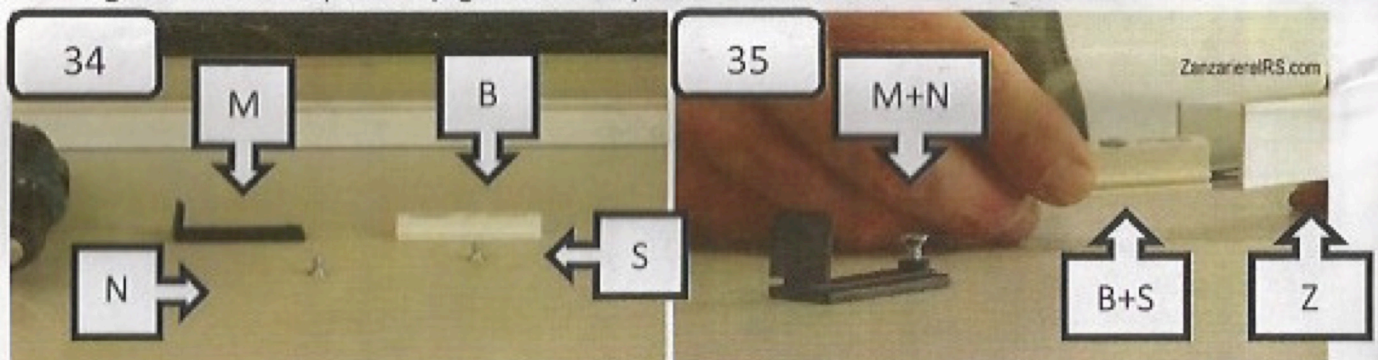

STEP 7

FOR RIGHT TO LEFT OPERATION, PROCEED AS FOLLOWS

Position the assembled roller cartridge (T) against the opening (figure 39).

The top end of the cartridge should project 30 mm beyond the top of the door (figure 40),

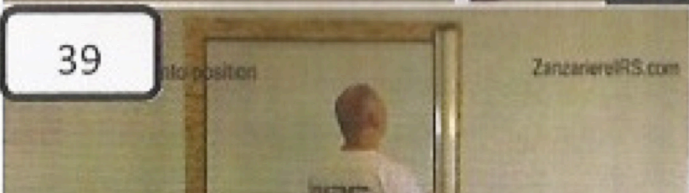
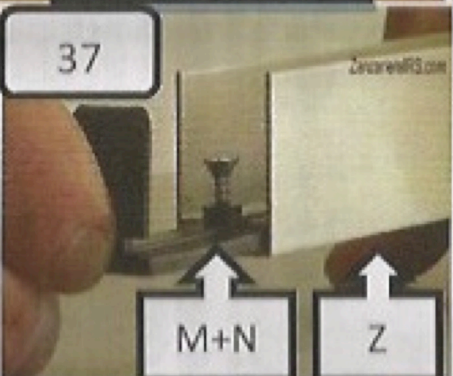
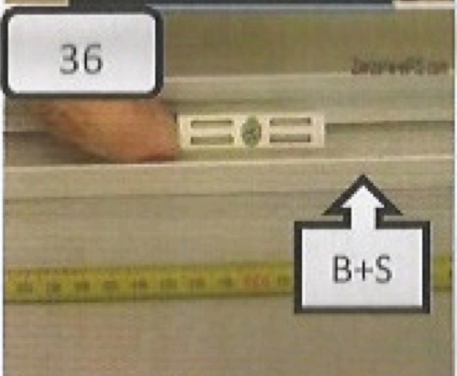
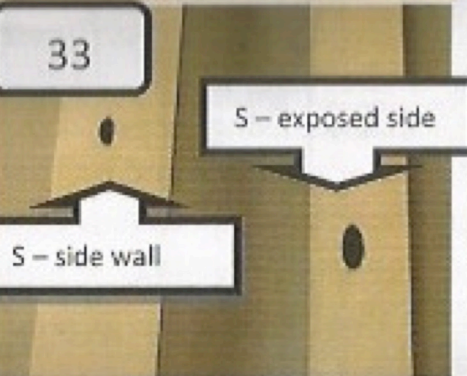
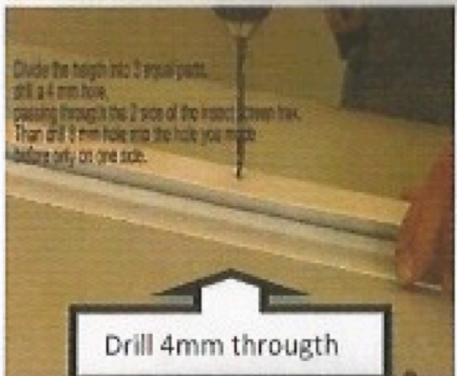
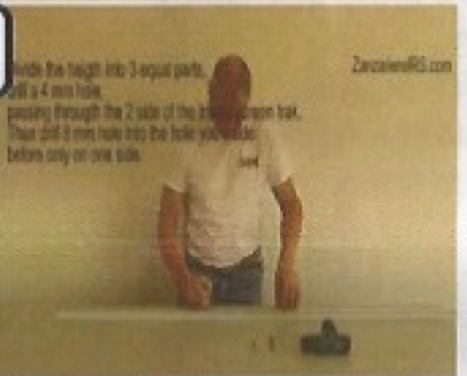
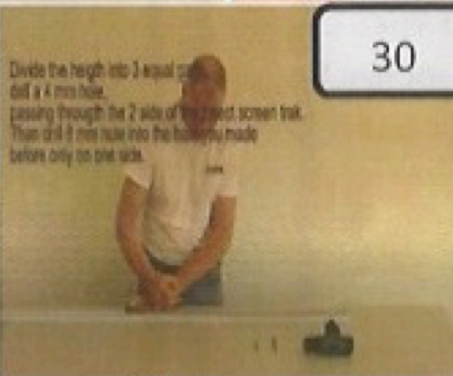
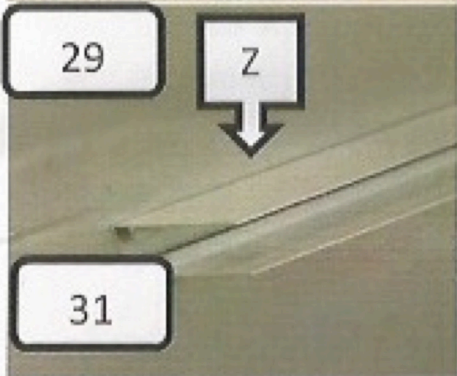
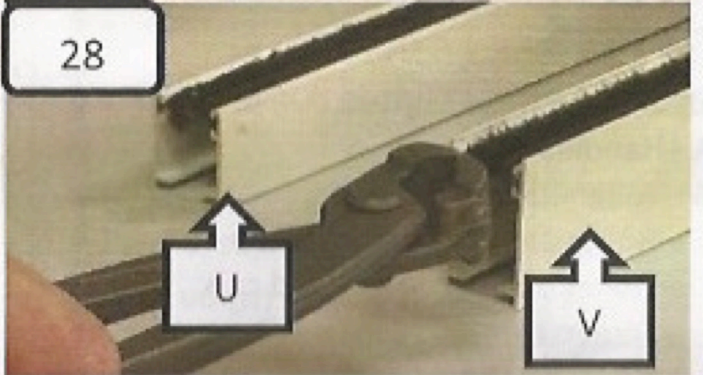
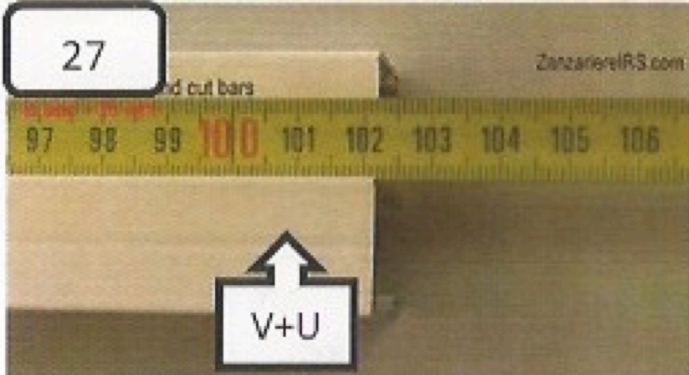
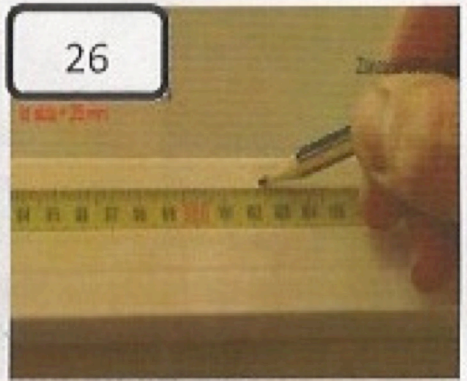
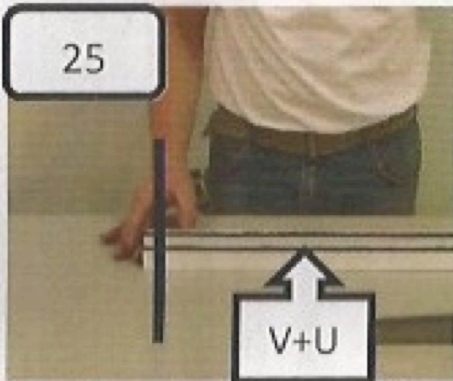
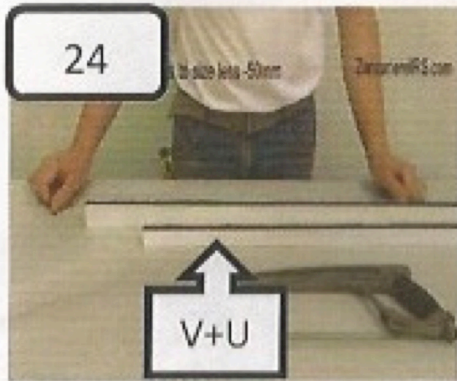

whilst the bottom part of the cartridge must be perfectly plumb and square with the opening.

Check that the cartridge is positioned correctly in relation to the opening.

Proceed to fix the cartridge in place with the screws provided. When fixing to the wall, first mark the position of each screw hole, then proceed to drill the masonry with a 6 mm bit, insert anchor plugs, and secure with the fixing screws (E).

(Figures 41-42)

**FOR LEFT TO RIGHT OPERATION, PROCEED AS FOLLOWS, STARTING FROM THE TOP LEFT
STEP 10**

1) Take the top track (V – 36 mm), which must be positioned over the door opening. Draw the screen out slightly with the pull bar so as to facilitate the positioning of the top track, which must be coupled to the relative appendage at the corresponding top end of the roller cartridge (figure 00). The other end of the track will be attached to the support (M) fitted in step 6 (figure 00).

1) Take the floor track (U – 25 mm), which will be positioned at the bottom of the door opening. Draw the screen out slightly with the pull bar so as to facilitate the positioning of the floor track, which must be coupled to the relative appendage at the corresponding bottom end of the roller cartridge (figure 46). The other end of the track will be attached to the support (M) fitted in step 6 (figure 47).

Check that the top track (V) and the floor track (U) are parallel with one another, and that the stop channel (Z) is parallel with the roller cartridge (T) fixed previously (figure 48).

Fix the stop channel (Z) in position with the screws (E) provided. When fixing to the wall, first mark the position of each screw hole, then proceed to drill the masonry with a 6 mm bit, insert anchor plugs, and secure with the fixing screws (E).

Conceal the fixing holes in the tracks with the plugs (P) (figure 51).



STEP 11

Draw the pull bar toward the stop channel (Z), to the point at which the catch plate on the bar enters into contact with the magnet located internally of the track (Z). Adjust the position of the magnet if necessary, so that the plate and the magnet are faultlessly aligned and come firmly together (figure 52)

To close – Draw the pull bar across and into contact with the magnet.

To open – Draw the pull bar away from the magnet and direct it back toward the roller cartridge, without letting go

